

SBCR10-4A-39

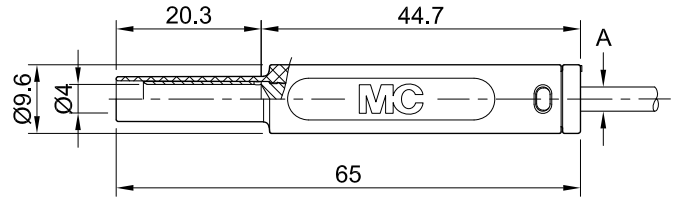

Item number 66.2053-*

In-line, rigid, Ø 4 mm, accepting spring-loaded Ø 4 mm plugs with rigid insulating sleeve, for self-assembly of test leads. Crimp connection.

Technical data	
Diameter of plug system	4 mm
Rated Values	1000 V, CAT II, 19 A / 600 V, CAT III, 19 A
Surface treatment electrical contact	Au
Base material electrical contact	CuZn
Standard color(s) *	21 22 23 24 25 29
Optional color(s)	20 26 27 28
Test accessory acc. to	IEC EN 61010-031
Approvals	UR